

THE FORUM AT GRANDVIEW

175 Grandview Boulevard, Madison, MS 39110
Madison County



HIGHLIGHTS

For Lease
County: Madison
Type: Retail
Total SF: 216,144

CONTACT

Evan Staley
404.926.1533
estaley@hendonproperties.com

The Forum at Grandview is the prime retail destination in Madison, MS, an affluent and growing suburb of Jackson. The center is highly visible to Interstate 55 and anchored by top national retailers Dick's Sporting Goods, Home Goods, Best Buy, Michaels, Petco, and ULTA. The architectural prominence stands out among the immediately adjacent retail including Wal-Mart, Sam's Club, Malco Theaters, and Miskelly Furniture. The site contains approximately 8 acres of developable outparcels.

The Madison market is rapidly growing at 2.6% annual rate boasting the highest average household income in Mississippi of \$122,000 (AHHI).

[Click here for a video tour of the property.](#)

RETAILERS INCLUDE



DEMOGRAPHICS

	3 MILES	5 MILES	7 MILES
Population	23,443	70,986	109,717
Daytime Population	20,756	45,622	60,327
Households	8,827	28,071	44,214
Average Household Income (\$)	136,419	117,429	107,080
Median Household Income (\$)	106,534	83,143	74,532
Median Age	39	39	39

THE FORUM AT GRANDVIEW

175 Grandview Boulevard, Madison, MS 39110
Madison County

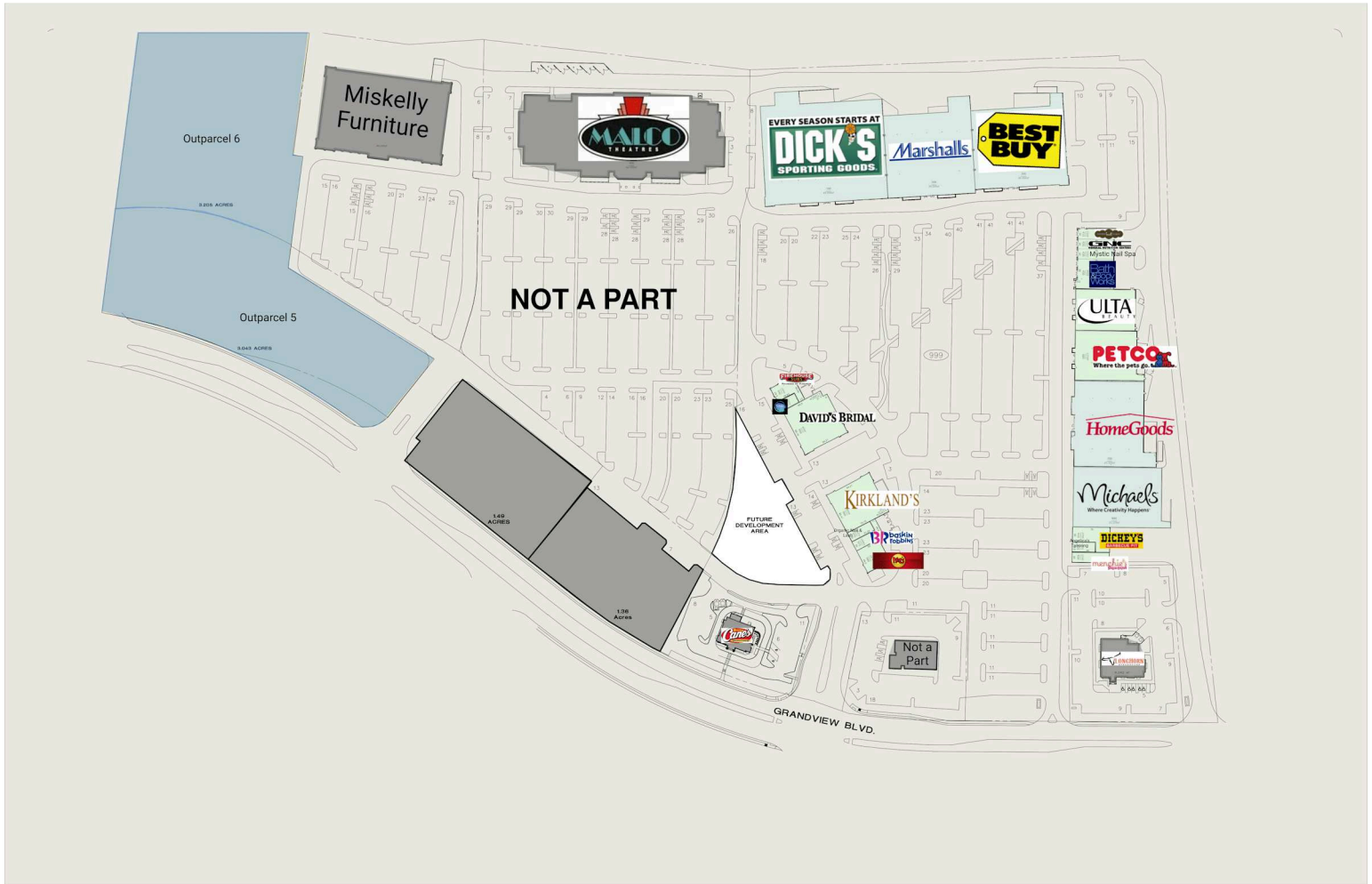

Outparcel 5 Available 3.04ac

Outparcel 6 Available 3.20ac

100	Dick's Sporting Goods	49,994SF
200	Marshalls	30,000SF
300	Best Buy	30,000SF
410	Nothing Bundt Cakes	1,500SF
420	GNC	1,593SF
430	Mystic Nail Spa	1,032SF
450	Bath & Body Works	4,600SF
500	Ulta	9,963SF
600	Petco	12,500SF
700	HomeGoods	25,000SF

800	Michaels	21,129SF
910	Dickey's BBQ Pit	2,200SF
920	Angelica's Tailoring	831SF
930	Menchie's	1,240SF
940	Firehouse Subs	1,800SF
945	Forum Nutrition	777SF
950	David's Bridal	9,000SF
960	Kirkland's	8,000SF
970	Organic Nail & Lash	1,025SF
975	Baskin Robbins	1,484SF
980	Moe's Southwest Grill	2,476SF

THE FORUM AT GRANDVIEW

175 Grandview Boulevard, Madison, MS 39110
Madison County

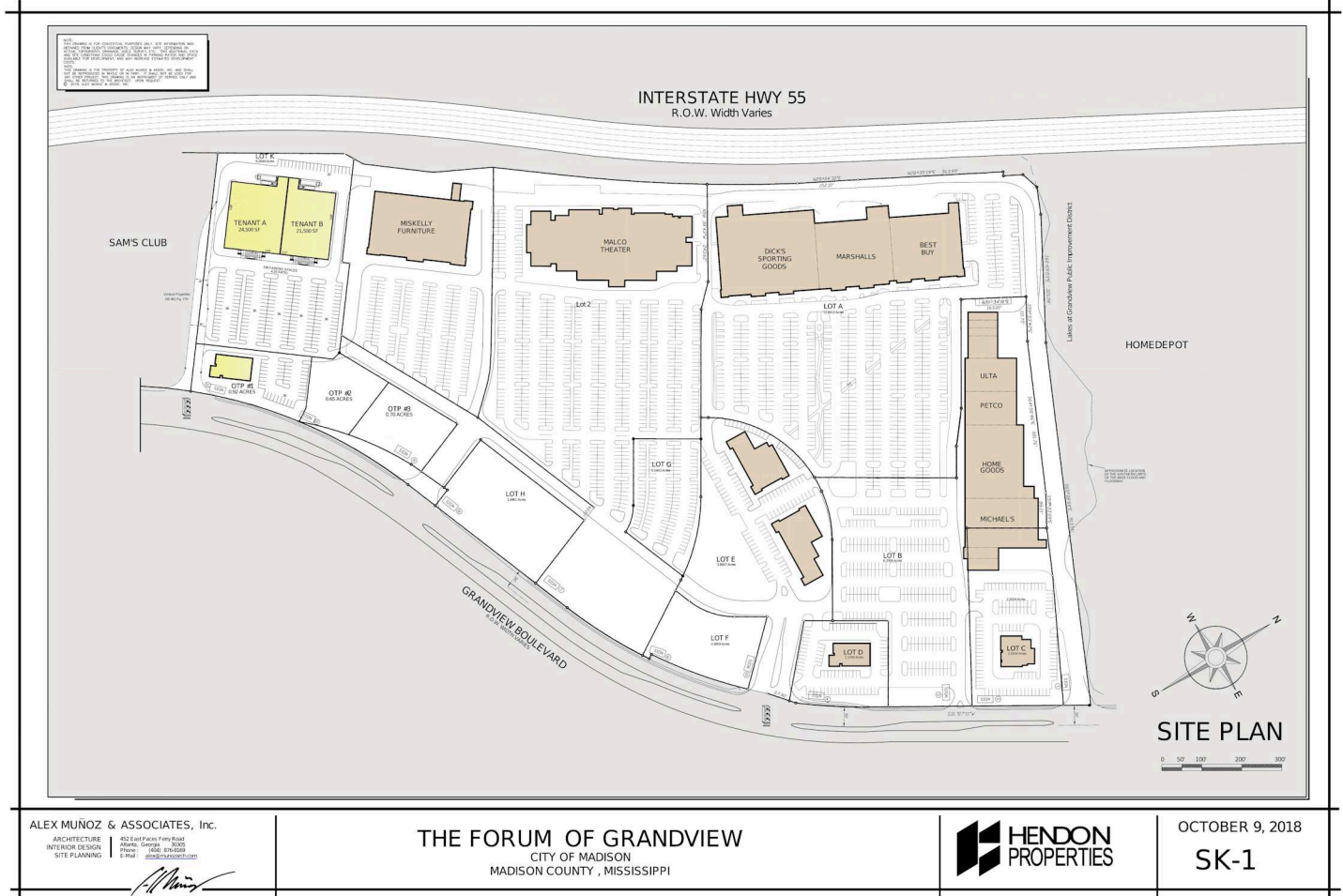

NAP 1	Miskelly Furniture			
NAP 2	Malco Theatre			
NAP 3	Raising Cane's			
NAP 4	Not a Part			
NAP 5	Longhorn Steakhouse			
Outparcel 5	Available	132,533SF		
Outparcel 6	Available	139,609SF		
100	Dick's Sporting Goods	49,994SF	500 Ulta	9,963SF
200	Marshalls	30,000SF	600 Petco	12,500SF
300	Best Buy	30,000SF	700 HomeGoods	25,000SF
410	Nothing Bundt Cakes	1,500SF	800 Michaels	21,129SF
420	GNC	1,593SF	910 Dickey's BBQ Pit	2,200SF
430	Mystic Nail Spa	1,032SF	920 Angelica's Tailoring	831SF
450	Bath & Body Works	4,600SF	930 Menchie's	1,240SF
			940 Firehouse Subs	1,800SF
			945 Grand View Nutrition	777SF
			950 David's Bridal	9,000SF
			960 Kirkland's	8,000SF
			970 Organic Nail & Lash	1,025SF
			975 Baskin Robbins	1,484SF
			980 Moe's Southwest Grill	2,476SF