

THE FORUM AT GRANDVIEW

175 Grandview Boulevard, Madison, MS 39110
Madison County



HIGHLIGHTS

For Lease
County: Madison
Type: Retail
Total SF: 216,144

CONTACT

Evan Staley
404.926.1533
estaley@hendonproperties.com

The Forum at Grandview is the prime retail destination in Madison, MS, an affluent and growing suburb of Jackson. The center is highly visible to Interstate 55 and anchored by top national retailers Dick's Sporting Goods, Home Goods, Best Buy, Michaels, Petco, and ULTA. The architectural prominence stands out among the immediately adjacent retail including Wal-Mart, Sam's Club, Malco Theaters, and Miskelly Furniture. The site contains approximately 8 acres of developable outparcels.

The Madison market is rapidly growing at 2.6% annual rate boasting the highest average household income in Mississippi of \$122,000 (AHHI).

[Click here for a video tour of the property.](#)

RETAILERS INCLUDE



DEMOGRAPHICS

	3 MILES	5 MILES	7 MILES
Population	22,757	72,066	110,422
Daytime Population	20,386	41,309	58,500
Households	8,605	28,634	44,951
Average Household Income (\$)	166,460	138,241	124,922
Median Household Income (\$)	126,087	101,194	89,050
Median Age	39	39	39

THE FORUM AT GRANDVIEW

175 Grandview Boulevard, Madison, MS 39110
Madison County

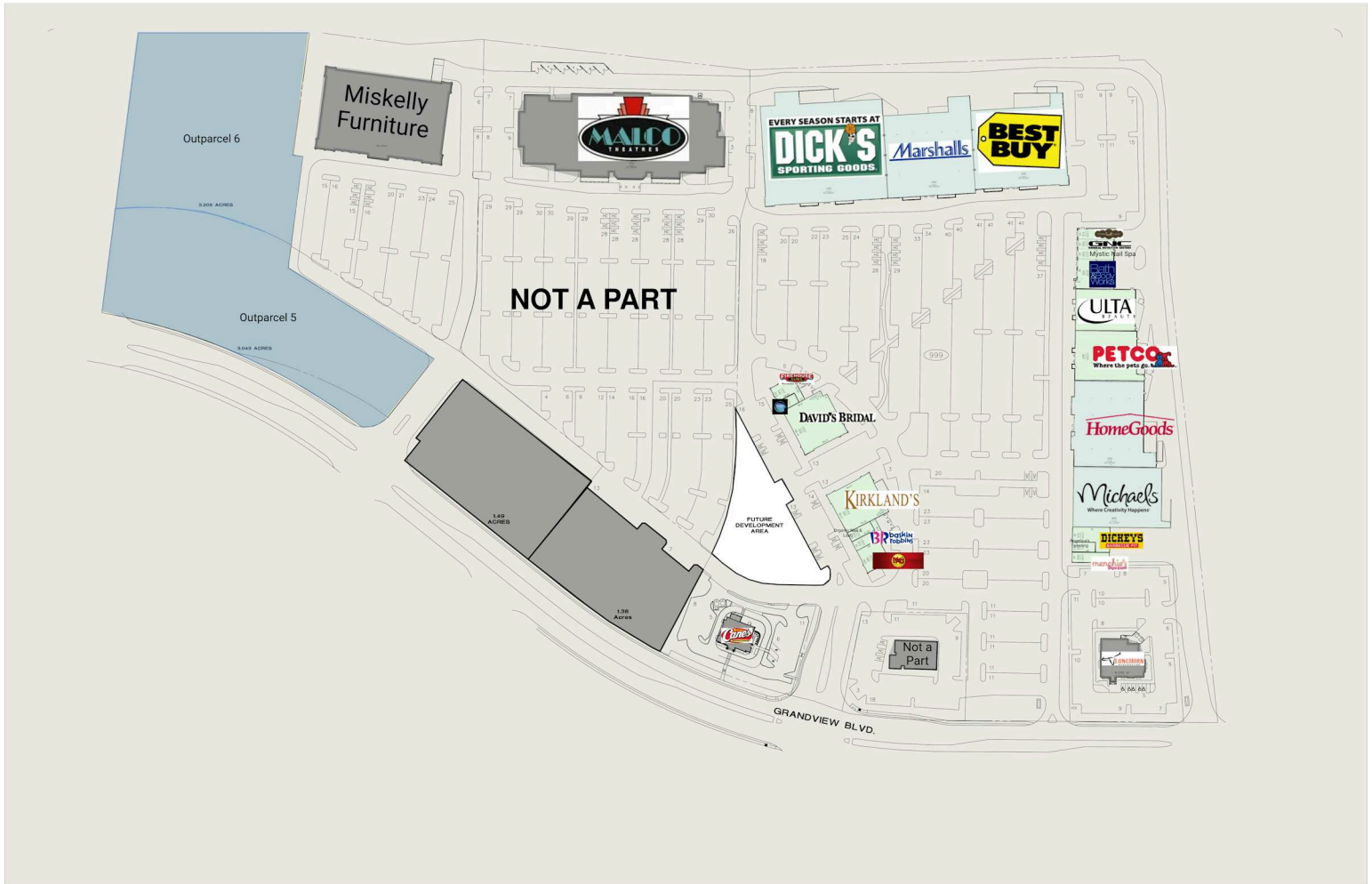

Outparcel 5 Available 3.04 AC

Outparcel 6 Available 3.2 AC

100	Dick's Sporting Goods	49,994 SF
200	Marshalls	30,000 SF
300	Best Buy	30,000 SF
410	Nothing Bundt Cakes	1,500 SF
420	GNC	1,593 SF
430	Mystic Nail Spa	1,032 SF
450	Bath & Body Works	4,600 SF
500	Ulta	9,963 SF
600	Petco	12,500 SF
700	HomeGoods	25,000 SF

800	Michaels	21,129 SF
910	Dickey's BBQ Pit	2,200 SF
920	Angelica's Tailoring	831 SF
930	Menchie's	1,240 SF
940	Firehouse Subs	1,800 SF
945	Forum Nutrition	777 SF
950	David's Bridal	9,000 SF
960	Kirkland's	8,000 SF
970	Organic Nail & Lash	1,025 SF
975	Baskin Robbins	1,484 SF
980	Moe's Southwest Grill	2,476 SF

THE FORUM AT GRANDVIEW

175 Grandview Boulevard, Madison, MS 39110
Madison County

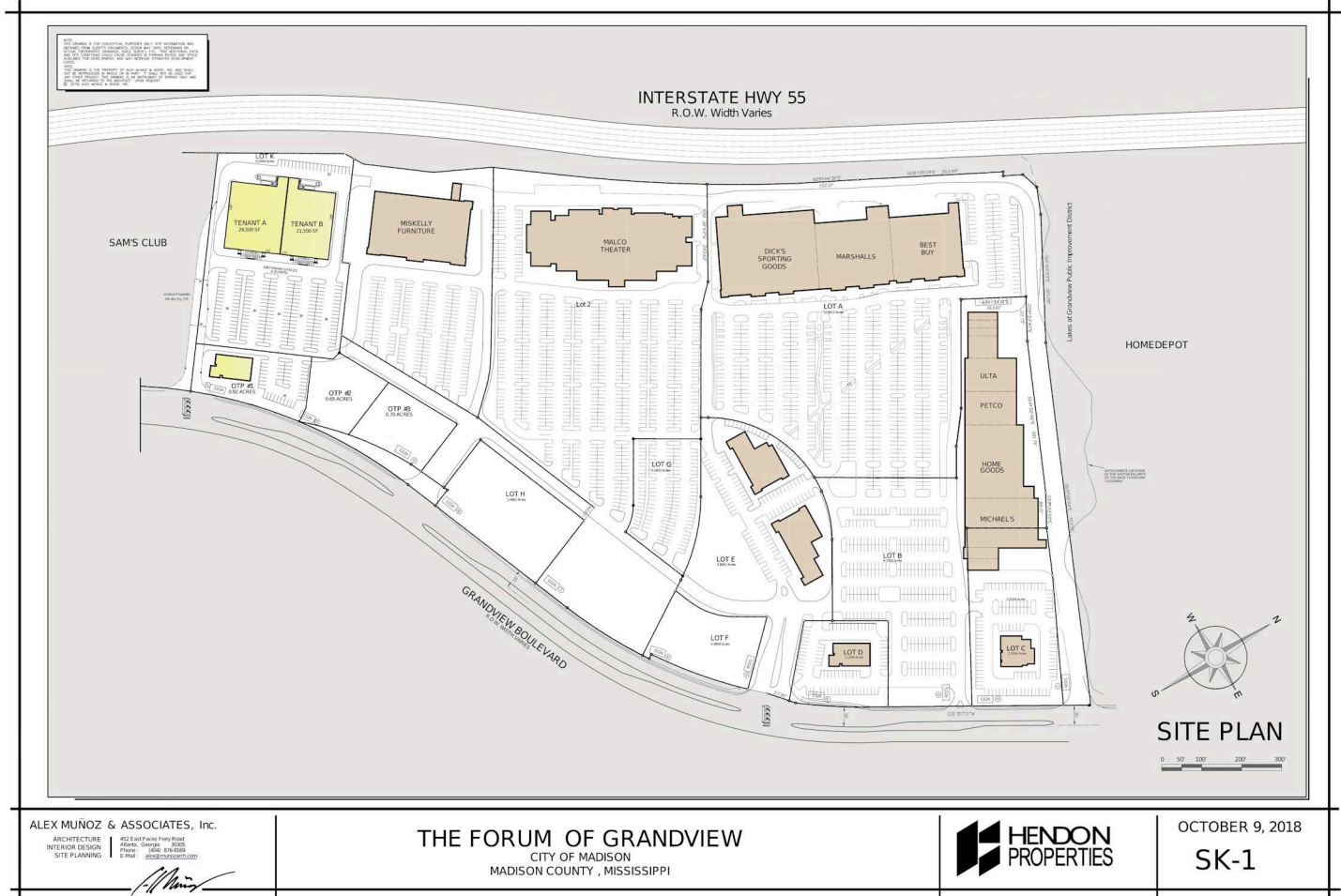

NAP 1	Miskelly Furniture		
NAP 2	Malco Theatre		
NAP 3	Raising Cane's		
NAP 4	Not a Part		
NAP 5	Longhorn Steakhouse		
Outparcel 5	Available	132,533 SF	
Outparcel 6	Available	139,609 SF	
100	Dick's Sporting Goods	49,994 SF	
200	Marshalls	30,000 SF	
300	Best Buy	30,000 SF	
410	Nothing Bundt Cakes	1,500 SF	
420	GNC	1,593 SF	
430	Mystic Nail Spa	1,032 SF	
450	Bath & Body Works	4,600 SF	
500	Ulta		9,963 SF
600	Petco		12,500 SF
700	HomeGoods		25,000 SF
800	Michaels		21,129 SF
910	Dickey's BBQ Pit		2,200 SF
920	Angelica's Tailoring		831 SF
930	Menchie's		1,240 SF
940	Firehouse Subs		1,800 SF
945	Grand View Nutrition		777 SF
950	David's Bridal		9,000 SF
960	Kirkland's		8,000 SF
970	Organic Nail & Lash		1,025 SF
975	Baskin Robbins		1,484 SF
980	Moe's Southwest Grill		2,476 SF