

GREENBRIAR MALL

2841 Greenbriar Pkwy SW, Atlanta, GA 30331
Fulton County



HIGHLIGHTS

For Lease
County: Fulton
Type: Retail
Total SF: 675,059
Parking Spaces: 2,917

CONTACT

Richard Wilson
404.542.8267
rwilson@hendonproperties.com

Monica Hawkins
404.629.3925
mhawkins@shopgreenbriar.com

Tanner Hendon
404.783.8674
thendon@hendonproperties.com

[Click here for a video about the property.](#)

- Located 5 miles away from Hartsfield Jackson Atlanta International Airport, the world's busiest airport.
- Convenient access to Interstate 285 (157,904 VPD) and Langford Parkway (20,201 VPD).
- An Atlanta landmark since 1965 with a unique mix of stores.
- Boasts a top sales volume Footlocker and Piccadilly Cafeteria.
- Convenient services including a Tag Office, U.S. Post Office, several hair & nail salons, multiple banks, a seven-restaurant food court, a dialysis center, a dental office, and many one-of-a-kind clothing stores.
- Goodyear Auto Service, Checkers, Popeyes, PNC Bank, AT&T, and Planet Fitness are located on mall outparcel lots.
- Four Outparcels available in +/- 1 to 1.5 acre lots.

RETAILERS INCLUDE



DEMOGRAPHICS

| | 3 MILES | 5 MILES | 7 MILES |
|-------------------------------|---------|---------|---------|
| Population | 69,297 | 157,820 | 299,248 |
| Daytime Population | 17,472 | 66,212 | 133,484 |
| Households | 30,142 | 67,047 | 122,875 |
| Average Household Income (\$) | 78,784 | 83,865 | 79,478 |
| Median Household Income (\$) | 56,100 | 58,161 | 55,485 |
| Median Age | 36 | 36 | 36 |

GREENBRIAR MALL

2841 Greenbriar Pkwy SW, Atlanta, GA 30331
Fulton County

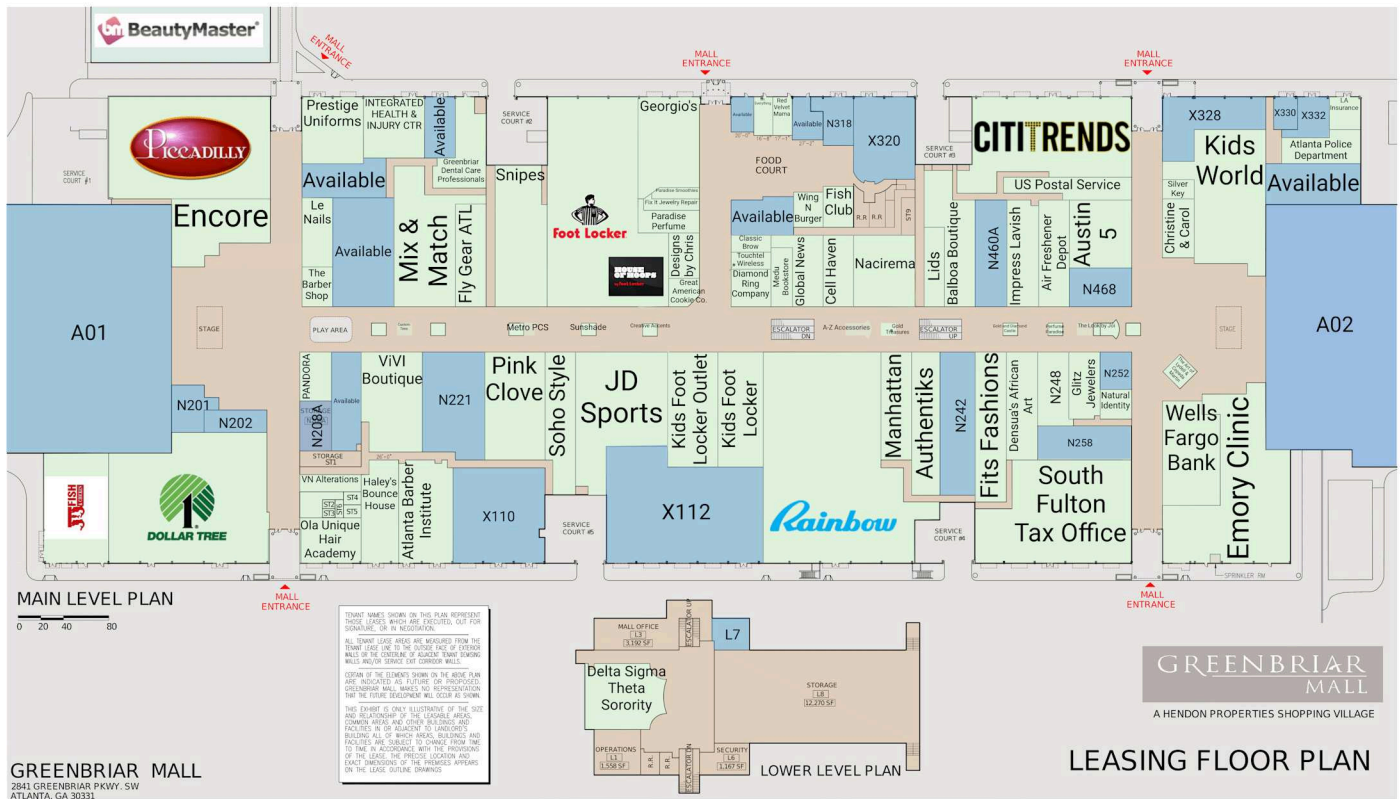

GREENBRIAR MALL

2841 Greenbriar Pkwy SW, Atlanta, GA 30331

Fulton County



| | | | | | |
|-------|-------------------------------|------------|--------|--------------------------------------|-----------|
| A01 | Available | 129,960 SF | N430 | Fix It Jewelry Repair | 517 SF |
| A02 | Available | 180,000 SF | N432 | Paradise Smoothies | 371 SF |
| A03 | Dollar Tree | 15,263 SF | N434 | Fish Club | 804 SF |
| A04 | Beauty Master | 34,000 SF | N436 | Wing N Burger | 1,023 SF |
| K07 | Gold Treasures | 144 SF | N438 | Available | 1,699 SF |
| N201 | Available | 1,292 SF | N440 | Classic Brow | 553 SF |
| N202 | Available | 1,027 SF | N442 | Touchtel Wireless | 548 SF |
| N206A | VN Alterations | 668 SF | N446A | Diamond Ring Company | 981 SF |
| N208 | PANDORA | 1,200 SF | N447 | Medu Bookstore | 954 SF |
| N208A | Available | 1,975 SF | N448 | Global News | 1,970 SF |
| N210 | Available | 2,500 SF | N450 | Cell Haven | 1,728 SF |
| N220 | ViVi Boutique | 4,786 SF | N452 | Nacirema | 3,504 SF |
| N221 | Available | 4,994 SF | N456 | Lids | 1,377 SF |
| N224 | Pink Clove | 5,101 SF | N458 | Balboa Boutique | 3,564 SF |
| N226 | Soho Style | 3,197 SF | N460A | Available | 2,536 SF |
| N228 | JD Sports | 7,500 SF | N462 | Impress Lavish | 2,614 SF |
| N233 | Kids Foot Locker Outlet | 4,000 SF | N464 | Air Freshener Depot | 2,543 SF |
| N234 | Kids Foot Locker | 5,000 SF | N468 | Available | 1,935 SF |
| N238 | Manhattan | 2,565 SF | N470 | Austin 5 | 3,305 SF |
| N240 | Authentiks | 2,498 SF | N472 | US Postal Service | 1,990 SF |
| N242 | Available | 3,296 SF | N476 | Silver Key | 491 SF |
| N243 | Fits Fashions | 3,390 SF | N478A | Christine & Carol | 1,502 SF |
| N246 | Densua's African Art | 2,538 SF | N480 | Kids World | 7,095 SF |
| N248 | ZJ Clothiers | 1,757 SF | P06 | The Art of Lydell & Cepada Martin | 400 SF |
| N250 | Glitz Jewelers | 1,602 SF | X101 | J&J Fish and Chicken | 5,483 SF |
| N252 | Available | 982 SF | X102 | Ola Unique Hair Academy | 2,023 SF |
| N254 | Natural Identity | 648 SF | X104 | Haley's Bounce House | 2,844 SF |
| N256 | Wells Fargo Bank | 4,522 SF | X106A | Atlanta Barber Institute | 4,315 SF |
| N258 | Available | 2,135 SF | X110 | Available | 6,990 SF |
| N300 | Piccadilly Cafeteria | 12,600 SF | X112 | Available | 13,776 SF |
| N315 | Red Velvet Mama | 534 SF | X120 | Rainbow | 23,378 SF |
| N316 | Available | 635 SF | X124-A | South Fulton Tax Office | 9,465 SF |
| N316A | Mr. Everything | 580 SF | X126 | Emory Clinic | 10,356 SF |
| N317 | Available | 891 SF | X302 | Prestige Uniforms | 3,240 SF |
| N318 | Available | 1,340 SF | X304 | INTEGRATED HEALTH & INJURY CTR | 2,960 SF |
| N402 | Available | 2,414 SF | X305 | Available | 1,497 SF |
| N404B | Le Nails | 691 SF | X306 | Greenbriar Dental Care Professionals | 2,295 SF |
| N405 | Encore | 4,087 SF | X310 | Georgio's | 4,611 SF |
| N406 | The Barber Shop | 933 SF | X320 | Available | 4,000 SF |
| N410A | Available | 5,244 SF | X326A | Citi Trends | 10,357 SF |
| N414/ | Mix & Match | 6,370 SF | X328 | Available | 3,125 SF |
| N416 | | | X330 | Available | 660 SF |
| N418 | Fly Gear ATL | 2,554 SF | X332 | Available | 1,055 SF |
| N420 | Snipes | 5,535 SF | X334 | LA Insurance | 836 SF |
| N422 | Foot Locker | 16,643 SF | X336 | Atlanta Police Department | 1,927 SF |
| N422A | House of Hoops by Foot Locker | | X338 | Available | 3,150 SF |
| N425 | Great American Cookie Co. | 694 SF | | | |
| N426 | Designs by Chris | 1,040 SF | | | |
| N428 | Paradise Perfume | 1,108 SF | | | |

GREENBRIAR MALL

2841 Greenbriar Pkwy SW, Atlanta, GA 30331
Fulton County

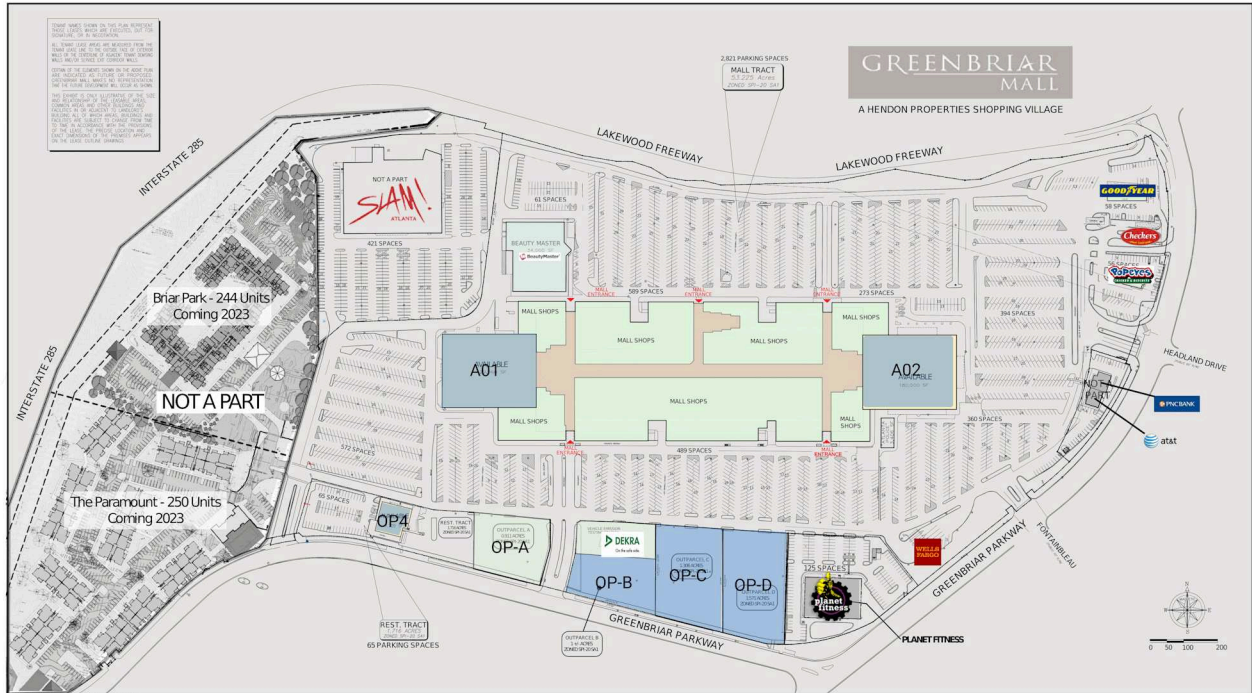

GREENBRIAR MALL
2841 GREENBRIAR PKWY SW
ATLANTA, GA 30331

LEASING SITE PLAN
EFFECTIVE DATE: MARCH 20, 2023

| | | |
|------|----------------|---------|
| A01 | Available | |
| A02 | Available | |
| A04 | Beauty Master | |
| OP-A | Under Contract | 0.91 AC |
| OP-B | Available | 1 AC |
| OP-C | Available | 1.31 AC |

| | | |
|------|--------------------------------|----------|
| OP-D | Available | 1.57 AC |
| OP2 | Popeye's | 2,400 SF |
| OP3 | Checker's | 628 SF |
| OP4 | Available | 7,709 SF |
| OP5 | Dekra Automotive North America | 1,152 SF |